



STL130/..-10.0-V-BLACK STLZ130/..-10.16-V-BLACK

Technical Data

Wire Sizes		Insulating Material	
Solid min	-	Material	PA 6.6
Solid max	-	Flammability Class	UL 94 V-0
Stranded (flexible) min		Temperatures	
Stranded (flexible) max	-	Operating Temperature	-30 °C - 105 °C
Stranded with Ferrule min		Wave Soldering Process	
Stranded with Ferrule max	-	Soldering Temperature, recommended	265 °C
Dimensions		Peak Soldering Time, recommended	3 s / 10 s
Stripped Length	-	Reflow Process	
PCB Hole Diameter	1.5 mm	Soldering Temperature, recommended	-
Materials		Peak Soldering Time, recommended	-
Contact Pin	Brass		

Colours

 BLACK, RAL 9011	 LIGHT GREY, RAL 7035
 GREEN, RAL 6018	 ORANGE, RAL 2011
 RED, RAL 3003	 BLUE, RAL 5015
 YELLOW, RAL 1018	 LIGHT GREEN, similar RAL 6018

Colours according to RAL, there may be variations on colour due to production conditions. Special colours on request.

Counterparts (Spacing 10.0 mm)

Terminal Block	
AK130	

Counterparts (Spacing 10.16 mm)

Terminal Block	
AKZ130	

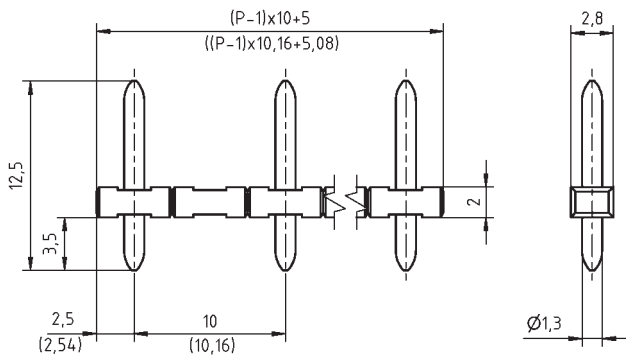

Order Data (Spacing 10.0 mm)



Poles	Width (mm)	Article Designation	Article Number	PU
2	15.00	STL130/2-10.0-V-BLACK	50130025021F	200
3	25.00	STL130/3-10.0-V-BLACK	50130035021E	100
4	35.00	STL130/4-10.0-V-BLACK	50130045021E	100
5	45.00	STL130/5-10.0-V-BLACK	50130055021E	100
6	55.00	STL130/6-10.0-V-BLACK	50130065021D	50
7	65.00	STL130/7-10.0-V-BLACK	50130075021D	50
8	75.00	STL130/8-10.0-V-BLACK	50130085021D	50
9	85.00	STL130/9-10.0-V-BLACK	50130095021D	50
...
12	115.00	STL130/12-10.0-V-BLACK	50130125021D	50

Order Data (Spacing 10.16 mm)

Poles	Width (mm)	Article Designation	Article Number	PU
2	15.24	STLZ130/2-10.16-V-BLACK	50130025071F	200
3	25.40	STLZ130/3-10.16-V-BLACK	50130035071E	100
4	35.56	STLZ130/4-10.16-V-BLACK	50130045071E	100
5	45.72	STLZ130/5-10.16-V-BLACK	50130055071E	100
6	55.88	STLZ130/6-10.16-V-BLACK	50130065071D	50

Black: 2- to 6-poles available

Ratings

Usegroup	c 			
	B	C	D	
Rated Voltage	300 V	150 V	300 V	630 V
Rated Current	10 A	10 A	10 A	7 A
Overvoltage Category				III
Test Voltage	1.6 kV	1.3 kV	1.6 kV	6.0 kV
Pollution Degree				3